

ASSEMBLY INSTRUCTIONS

ITEM No.:HRN.KD.CT

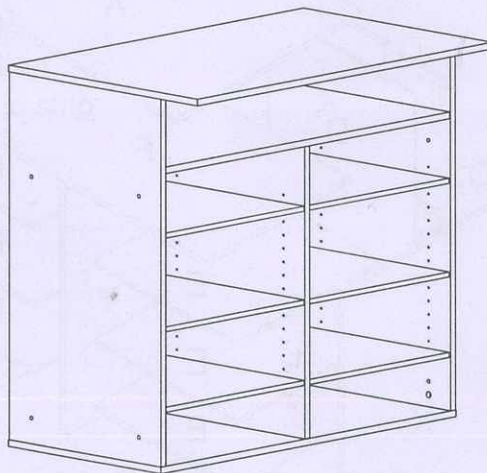



Turn clockwise to lock cam with bolt.



The arrow direction=front

Incorrect Correct

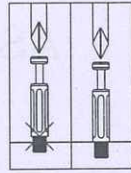

Screw cam bolts all the way in.

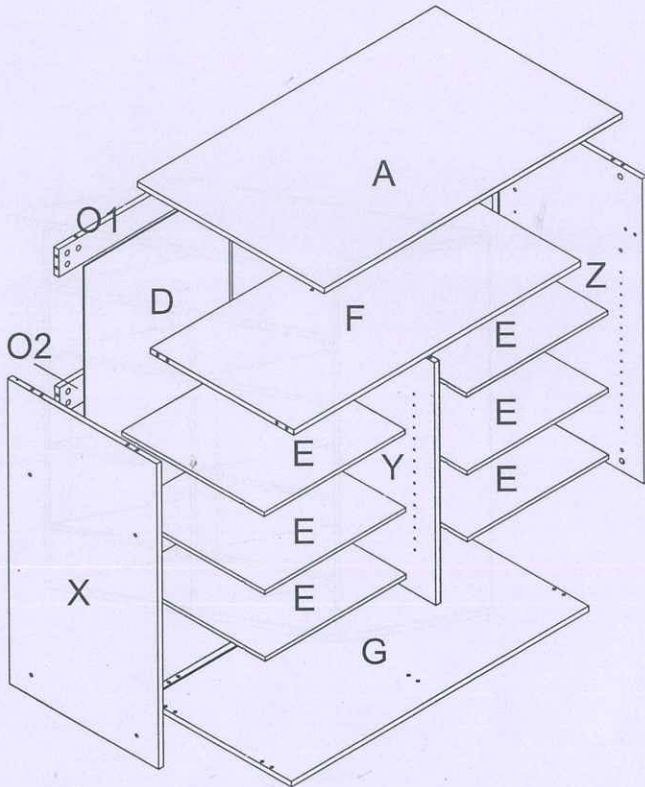

PARTS LIST

ITEM	DESCRIPTION	QTY.
A	Top panel	1
G	Bottom panel	1
D	Back panel	2
X	Left side panel	1
Z	Right side panel	1
E	Moveable shelf	6
F	Shelf panel	1
O1	Panel	2
O2	Panel	1
Y	Partition	1
	Plastic strip	2

PARTS LIST

ITEM	DESCRIPTION	QTY.	ITEM	DESCRIPTION	QTY.
(c1)	6*35 Cam Bolt	34	(b1)	6*30 Fix Bolt	4
(d1)	8*30 Dowel pin	20	(c3)	Cover	4
(c2)	($\frac{7}{8}$ ") Cam Cover	34	(s5)	Feet	6
(p1)	Threaded Dowel Pin	24	(a)	Wrench	1
			s1	3.5*30 Screw	2
			s2	3.5*14 Screw	2



(c1) 6*35 Cam Bolt-34

(d1) 8*30 Dowel Pin-20

(c2) ($\frac{7}{8}$ ") Cam Cover-34



(s5) Alignment Pin-6

a Wrench-1

(p1) Threaded Dowel Pin-24



(b1) 6*30 Fix Bolt-4

(c3) Cover-4

s1 3.5*30 Screw-2



s2 3.5*14 Screw-2

Pre-installed parts



(c5) Cam

STEP 1

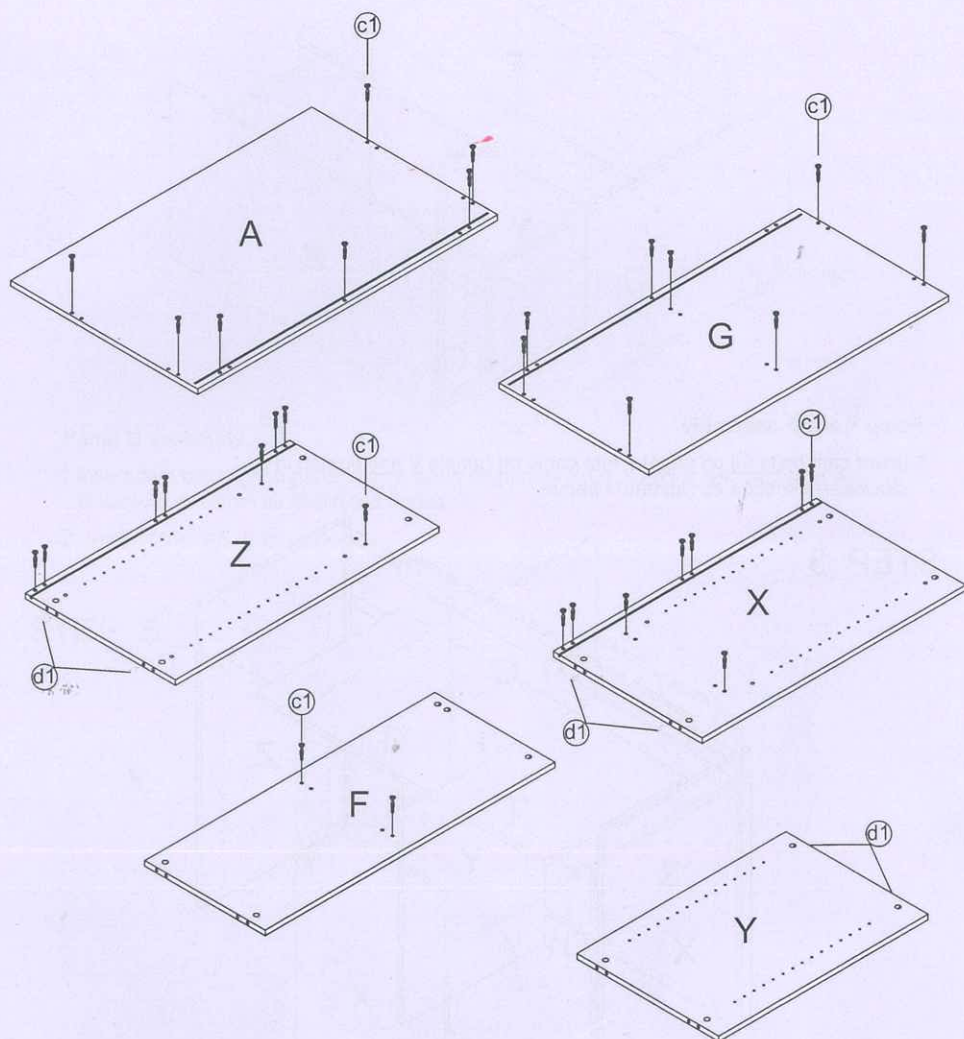

Preparing panel A.G.X.Z.F.Y and O.

1. Insert cam bolts (c1) into panels A.G.X.Z.F.O and Y as illustrated above.
2. Insert dowel pins (d1) to panels X,Z and Y as illustrated above.

Fix Ball catch b3 using Screw s1 to panels X,Z and O as illustrated above.

STEP 2

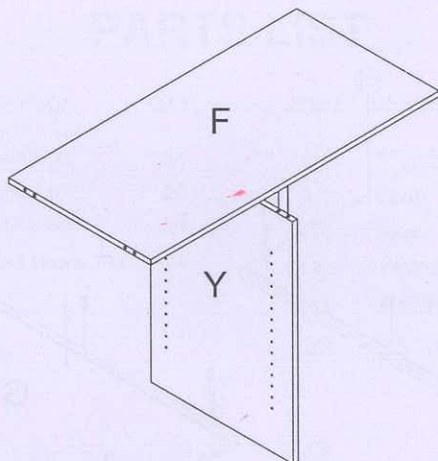

Panel Y and F assembly.

1. Insert cam bolts (C) on panel F into cams on panels Y and tighten in a clockwise direction as illustrated above.

STEP 3

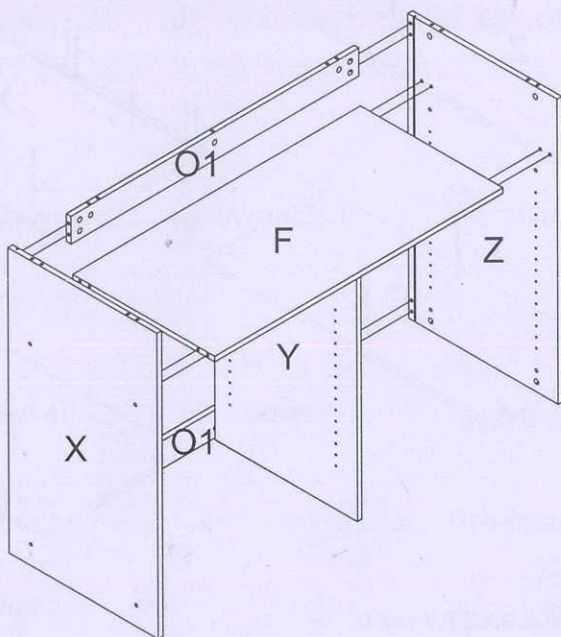

Panel O1.O2.X and Z assembly.

1. Insert cam bolts (C) on panel X and Z into cams on panels F.O1.O2 and tighten in a clockwise direction as illustrated above.

STEP 4

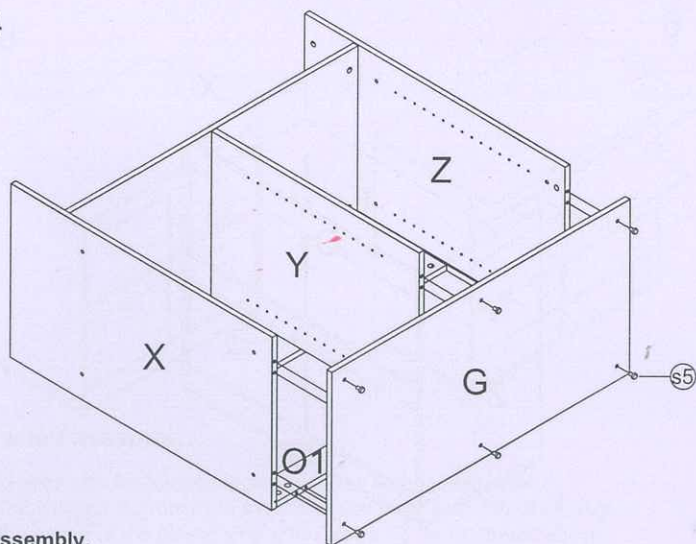

Panel G assembly.

1. Insert cam bolts (s1) on panel G into cams on panels Y, O1, X and Z and tighten in a clockwise direction as illustrated above.
2. Insert feet (s5) into panel G.

STEP 5

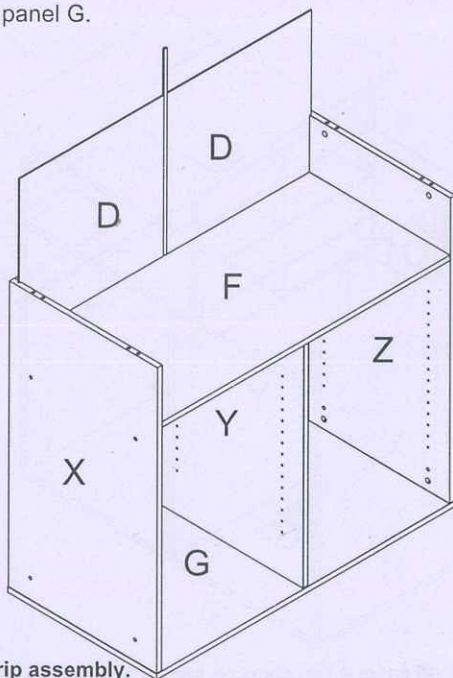

Panel D and Plastic strip assembly.

1. Insert panel D and Plastic strip into panel X, Z and G illustrated above.

STEP 6

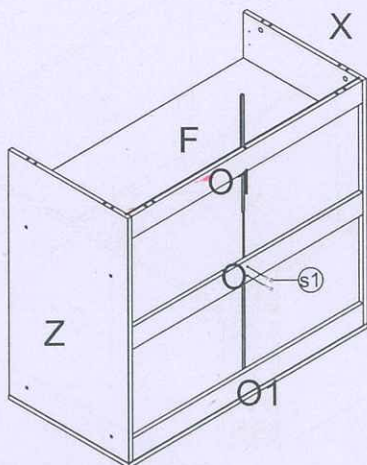

1. Connect panel O with screws (S1) as illustrated above.

STEP 7

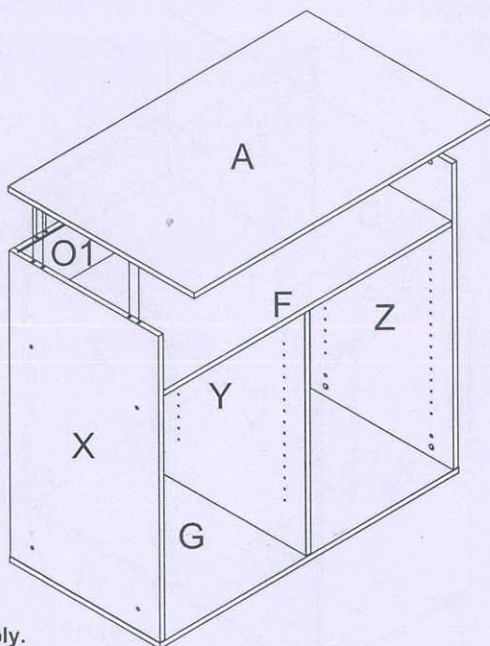

Panel A assembly.

1. Insert cam bolts (C) on panel A into cams on panels O1.X and Z and tighten in a clockwise direction as illustrated above.

STEP 8

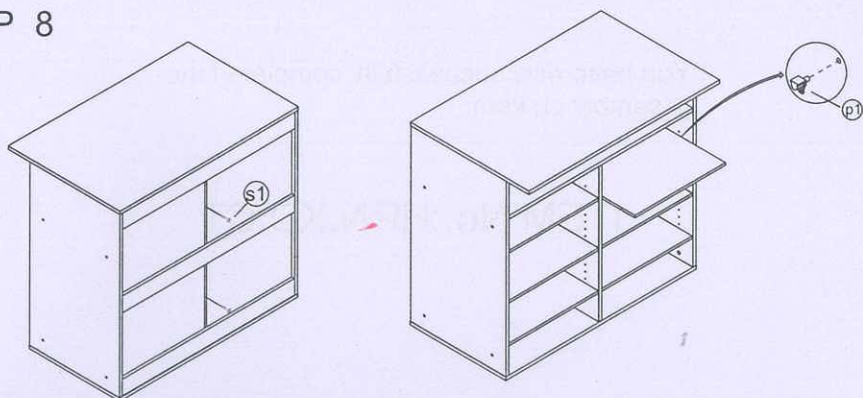

Moveable shelf assembly.

1. Press in (p1) pegs with flat surface facing upwards at the same level.
2. Slide shelf E with cut in grooves (if available) downwards on top of (p1) pegs.
3. Connect the centre of the plastic strip with screws (s2) as illustrated above.

STEP 9

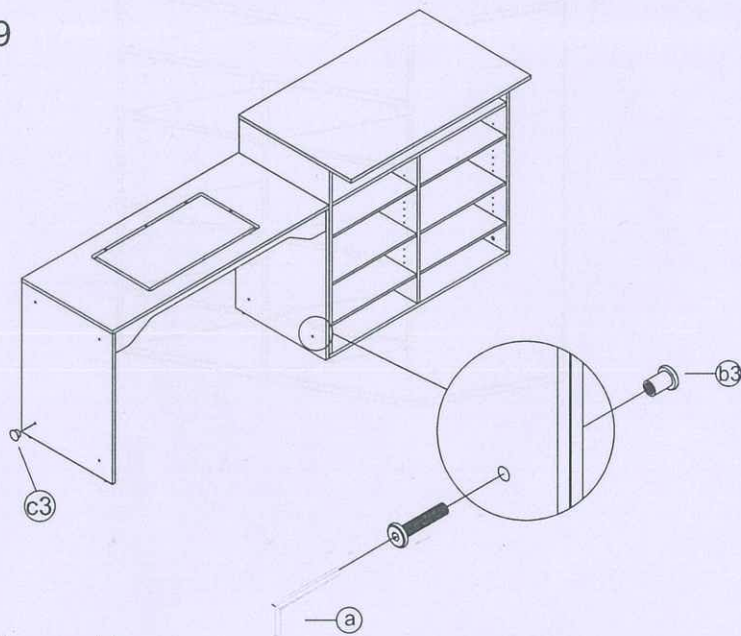

Fix Bolt assembly.

1. Connecting Cupboard A and B is using Wrench (a) to insert Fix Bolt (b3) as illustrated above.